

State of Wyoming Corner Record

(In compliance with the *CORNER PERPETUATION AND FILING ACT*, Wyoming Statutes, 1997, Section 33-29-140, et. seq., and the Rules and Regulations of the Board of Registration for Professional Engineers and Professional Land Surveyors)

Reverse side of this form may be used if more space is needed.

Record of original survey and citation of source of historical information (if corner is lost or obliterated). Description of corner monumentation evidence found and/or monument and accessories established to perpetuate the location of this corner. Sketch of relative location of monument, accessories, and reference points with course and distance to adjacent corner(s) (if determined in this survey). Method and rationale for reestablishment of lost or obliterated corner.

G.L.O. and Subsequent Records: See previously filed State of Wyoming Corner Record filed by me on 3/28/2003, Book 1712, Page 889.

The above mentioned State of Wyoming Corner Record indicates I set a No. 5 x 24" rebar with 2 1/2" diameter aluminum cap. The monument was removed during the construction phase of the Wyoming Department Transportation Project No. 0C02-00(071) Burns North. Upon the completion of the construction phase and at the request of the Wyoming Department of Transportation, I reset the above monument with a No. 5 x 24" rebar and 3 1/4" diameter Brass Cap marked as noted below, 0.1' below the recently constructed asphalt roadway.

Brass Cap Markings

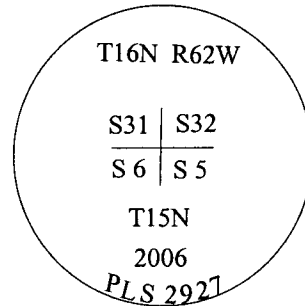

Date of Field Work: 7 September 2006

Office Reference: Burns North 26109

CROSS INDEX DIAGRAM

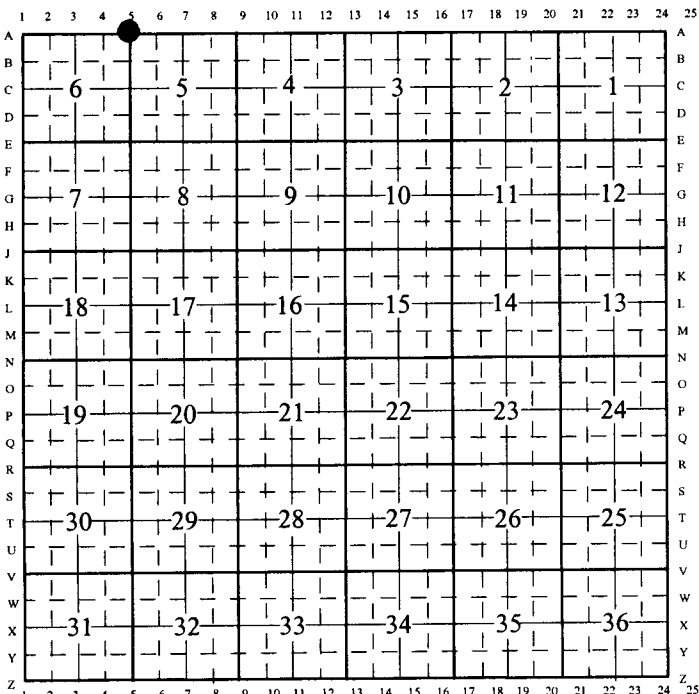

Firm/Agency, Address

Paul A. Reid, PLS
1533 Pinion Drive
Cheyenne WY
Phone (307) 637-3400

This corner record was prepared by me or under my direction and supervision.

SEAL & SIGNATURE

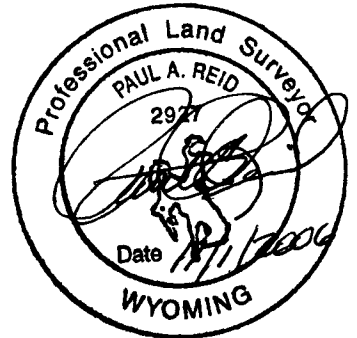

 RECORDED 11/01/2006 AT 8:55 AM REC# 460491 K# 1977 PG# 1
 DEBRA K. LATHROP, CLERK OF LARAMIE COUNTY, WY PAGE 1 OF 1

Corner Name: Northwest Corner Section: 5 T.15 N., R. 62 W., 6th P.M.
SBRPEPLS/PLSW: MARCH 1994/97

Cross-Index No.: A-5 (T15N,R62W)
Z-5 (T16N,R62W)